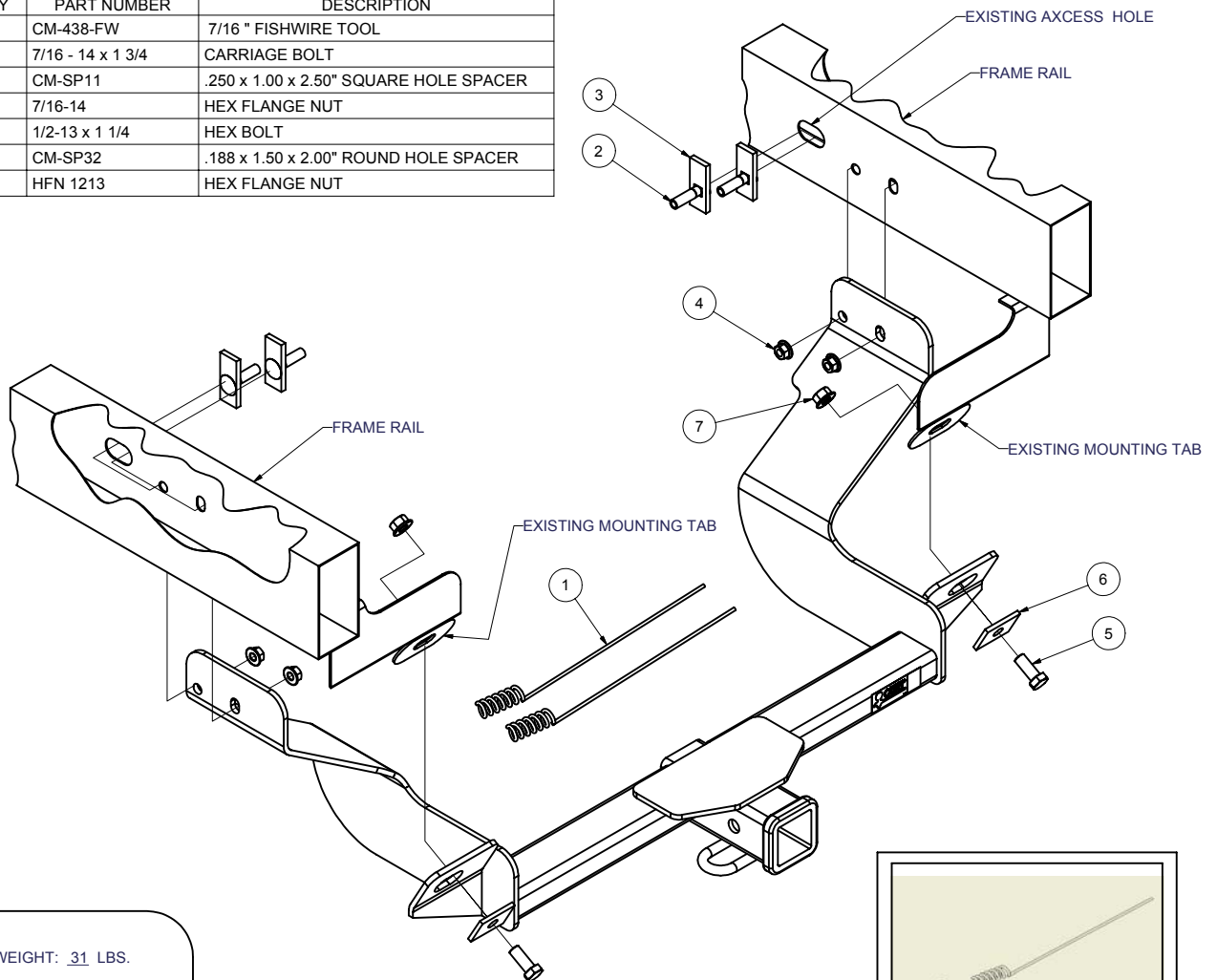

**13527****CHRYSLER PACIFICA****10/22/2007**

**GROSS LOAD CAPACITY WHEN USED AS A WEIGHT CARRYING HITCH: 3,500 LBS. TRAILER WEIGHT & 350 LBS. TONGUE WEIGHT.**  
**\*\*\*DO NOT EXCEED VEHICLE MANUFACTURER'S RECOMMENDED TOWING CAPACITY.\*\*\***

Parts List			
ITEM	QTY	PART NUMBER	DESCRIPTION
1	2	CM-438-FW	7/16" FISHWIRE TOOL
2	4	7/16 - 14 x 1 3/4	CARRIAGE BOLT
3	4	CM-SP11	.250 x 1.00 x 2.50" SQUARE HOLE SPACER
4	4	7/16-14	HEX FLANGE NUT
5	2	1/2-13 x 1 1/4	HEX BOLT
6	2	CM-SP32	.188 x 1.50 x 2.00" ROUND HOLE SPACER
7	2	HFN 1213	HEX FLANGE NUT

HITCH WEIGHT: 31 LBS.INSTALL TIME: 45 MINUTES

INSTALL NOTES:

-NO DRILLING REQUIRED

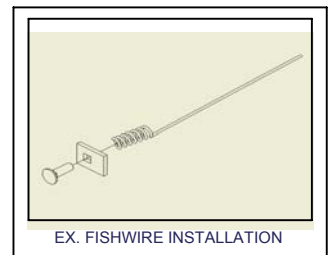
**INSTALLATION STEPS**

- 1) Lower exhaust and spare tire for ease of installation.
- 2) Raise hitch into position and secure with 1/2" hex bolts, spacers and flange nuts as shown, finger tight.
- 3) Fishwire (4) 7/16" carriage bolts and spacers through existing access hole in frame rail into hitch and secure with flange nuts as shown.
- 4) Torque all 7/16" hardware to 50 lb-ft and all 1/2" hardware to 75 lb-ft.
- 5) Replace exhaust and spare tire removed in step 1. (**NOTE:** Raise one side of spare tire over passenger side plate first and then raise other side of spare over driver side plate.)

**PERIODICALLY CHECK THIS RECEIVER HITCH TO ENSURE THAT ALL FASTENERS ARE TIGHT AND THAT ALL STRUCTURAL COMPONENTS ARE SOUND.**

Curt Manufacturing Inc., warrants this product to be free of defects in material and/or workmanship at the time of retail purchase by the original purchaser. If the product is found to be defective, Curt Manufacturing Inc., may repair or replace the product, at their option, when the product is returned, prepaid, with proof of purchase. Alteration to, misuse of, or improper installation of this product voids the warranty. Curt Manufacturing Inc.'s liability is limited to repair or replacement of products found to be defective, and specifically excludes liability for incidental or consequential loss or damage.